



207/47 Chippen Street Chippendale NSW

1 1 1

ARRANGING AN INSPECTION IS EASY AND INSTANT -
DETAILS BELOW

This elevated one bedroom apartment delivers a modern open plan layout and access to onsite resort style facilities offering outdoor swimming pool, sauna, gymnasium and rooftop terrace. It occupies the second floor in the secure Waldorf complex, an easy city commute in close proximity to The University of Sydney, Ultimo TAFE, UTS, Central Train Station and the many art, dining and shopping attractions.

Featuring a neat & well equipped furnished 1 double bedroom unit with built in, combined lounge/dining, air-conditioning, dishwasher, gas cooking, internal laundry with washing machine & dryer and a secure basement car space.

All furniture and appliances included.

View : <https://www.nickolasproperties.com.au/lease/nsw/sydney-city/chippendale/residential/apartment/5881920>



Anthony Bouzanis
8354 1444

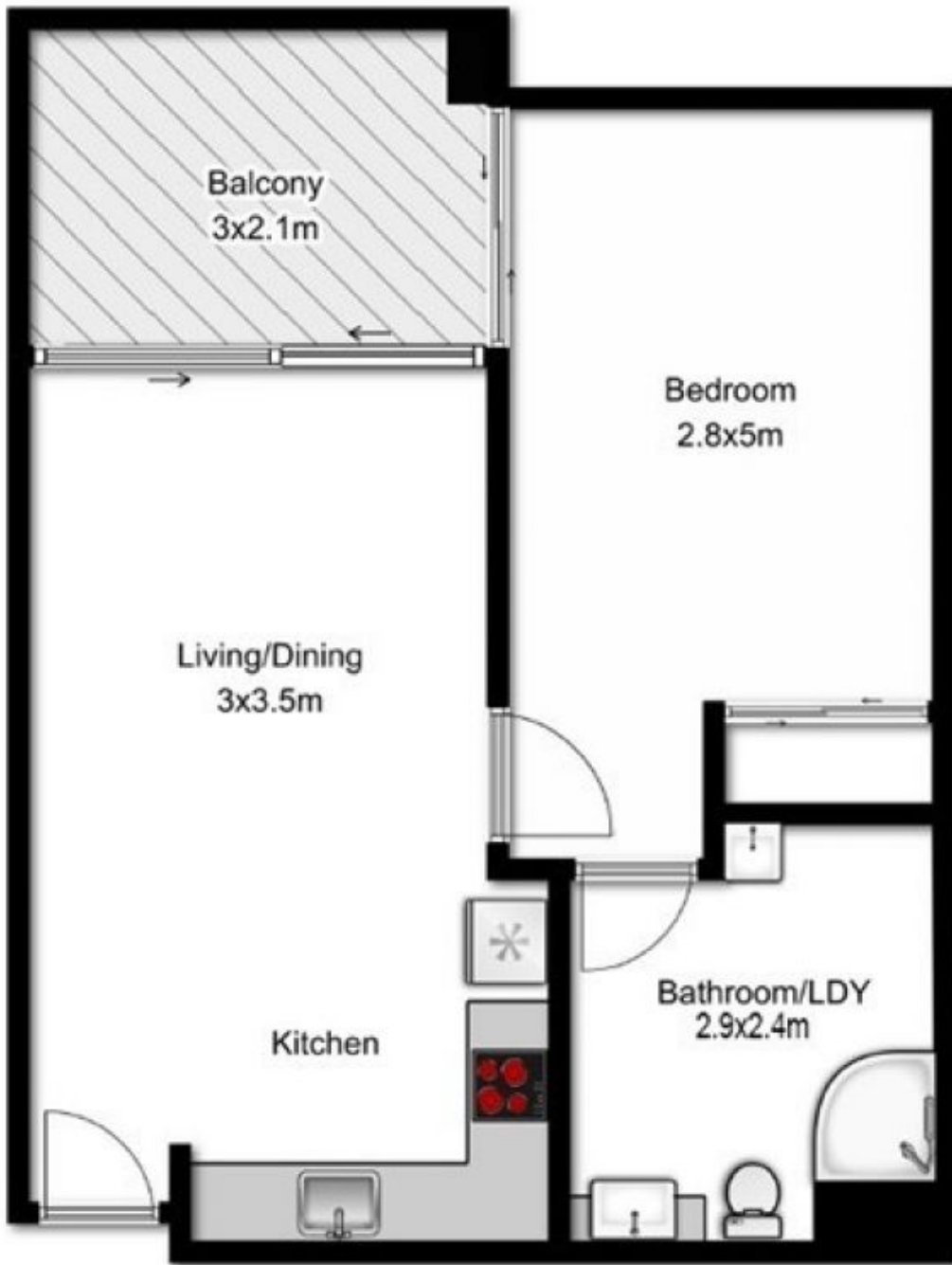

Internal area = 39 sqm approx.
Total = 57sqm approx.